

ALC18 / ALST8 Timer



ALC18



ALST8

Application

The time switch, applicable to circuit with rated voltage 230V AC and rated current 16A, "opens" after a predetermined time from actuation.

Construction and Feature

- Suitable to control wide range lightings include incandescent lamp, halogen lamp and fluorescent lamp
- Simple time setting
- With time delay
- Extremely compact and modular size

Technical Data

- Rated voltage: 230V~
- Rated frequency: 50Hz
- Consumption: 1VA
- Contact capacity: 16A 250V AC (COS ϕ =1)
- Electrical endurance: 10⁵ cycles
- Mechanical endurance: 10⁷ cycles
- Ambient temperature: -20°C~+50°C
- Connection terminal: pillar terminal with clamp
- Installation:
 - On symmetrical DIN rail
 - Panel mounting

ALC18 Timer

- Type: electronic time delay
- Time setting range: 20minutes
- Min. setting interval: 5minutes
- Slide switch: manual/automatic
- Controlled lighting load:
 - Incandescent lamp: 2300W
 - Halogen lamp: 2300W
 - Fluorescent lamp load with electronic ballast: 800W
- Switching: immediate reset

ALST8 Timer

- Type: electromechanical type with time delay
- Time setting range: 7 minutes
- Min. setting interval: 30 seconds
- Toggle switch: manual/automatic
- Controlled lighting load:
 - Incandescent lamp: 2300W
 - Halogen lamp: 2300W
 - Fluorescent lamp:
 - Uncompensated 2300W
 - Compensated in series: 2300W
 - Compensated in parallel: 1300W
- Switching: reset after 30s

Overall & Installation Dimensions

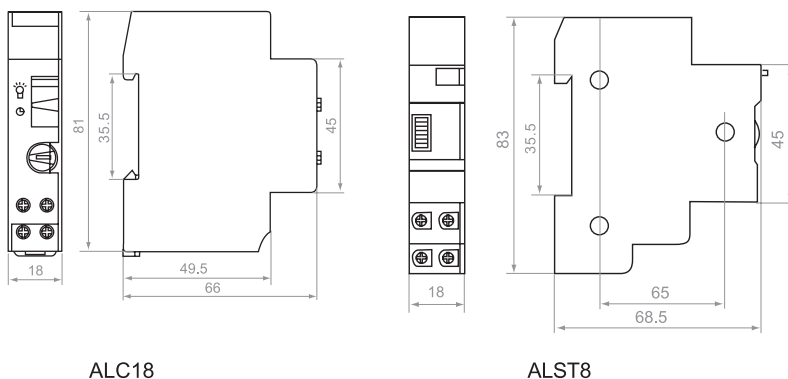

SUL180A Timer



Application

Switches "ON" and "OFF" automatically following a pre-determined program. The product is suitable in use for domestic, commercial and industrial installations.

Construction and Feature

- Available with or without power reserve
- 24 hour dial with 15 min segments
- Permanent ON/OFF switch
- Switching status indication

Technical Data

- Rated voltage: 230V AC
- Rated frequency: 50/60Hz
- Consumption: 2.5VA
- Contact: 1NO
- Contact capacity:
 - 16A/250V AC (COSØ=1)
 - 4A/250V AC (COSØ=0.6)
- Electrical endurance: 10⁵ cycles
- Mechanical endurance: 10⁷ cycles
- 24 hours
- 96 segments
- Min. programmable interval: 15 minutes
- Ambient temperature: -10°C~+50°C
- Connection terminal: pillar terminal with clamp
- Connection capacity: rigid conductor 6mm²
- Installation
 - On symmetrical DIN rail
 - Panel mounting

E

SUL180A Quartz time switch with power reserve

- Drive: quartz-controlled motor
- Frequency: 50/60Hz
- Accuracy: within ±1s per day at 20°C
- Reserve: 70 hours

Overall & Installation Dimensions

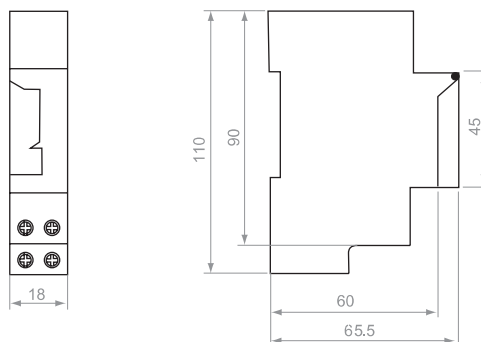

SUL181H Timer



E



Application

Switches "ON" and "OFF" automatically following a pre-determined program by means of riders fixed on the dial. The product is suitable in use for domestic, commercial and industrial installations.

Construction and Feature

- Available with or without power reserve
- 24 hour dial with 30 min segments
- Permanent ON/OFF switch
- Switching status indication
- Operating indication

Technical Data

- Rated voltage: 230V AC
- Rated frequency: 50/60Hz
- Consumption: 2.5VA
- Contact capacity: 16A/250V AC cycles
- Electrical endurance: 10^5 cycles
- Mechanical endurance: 10^7 cycles
- 24 hours program
- 48 segments
- Min. programmable interval: 30 minutes
- Ambient temperature: $-20^{\circ}\text{C} \sim +50^{\circ}\text{C}$
- Connection terminal: pillar terminal with clamp
- Connection capacity: rigid conductor 6mm^2
- Installation
 - On symmetrical DIN rail
 - Panel mounting

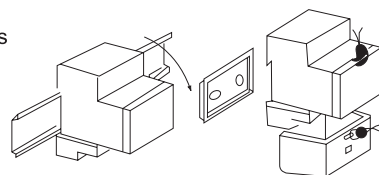

SUL181H Quartz time switch with power reserve

- Drive: quartz-controlled motor
- Frequency: 50/60Hz
- Accuracy: within $\pm 1\text{s}$ per day at 20°C
- Reserve: 150 hours

Overall & Installation Dimensions

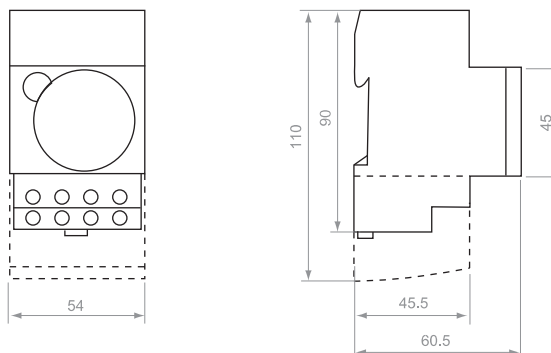

AHC15A Timer



Application

The product is applicable to circuit with rated current 16A, rated voltage 250V and rated frequency 50/60Hz. It provides independent electrical control to switch on-off the circuit at programmed times and days of the week.

Construction and Feature

- Compact modular size
- LCD Display
- Equipped with back-up battery
- Permanent switch ON/OFF

Technical Data

- Type: electronic with LCD display
- Rated voltage: 230V AC
- Rated frequency: 50/60Hz
- Contact: 1NO+1NC
- Consumption: maximum 4VA
- Contact capacity:
 - 16A/250V AC (COSØ=1).
 - 2.5A/250V AC (COSØ=0.6)
- Incandescent lamp: 1000W
- Electrical endurance: 10^5 cycles
- Mechanical endurance: 10^7 cycles
- Time basis: quartz
- 24 hours+ week program
- Working precision: ≤ 2 sec/day (25°C)
- Min. programmable interval: 1 minute
- Power reserve: min. 15 days
- Ambient temperature: -10~40°C
- Humidity: 35-85% RH
- Connection terminal: pillar terminal with clamp
- Connection capacity: rigid conductor 6mm²
- Installation
 - On symmetrical DIN rail
 - Panel mounting

E

Overall & Installation Dimensions

