

SUL181H Timer



Application

Switches "ON" and "OFF" automatically following a pre-determined program by means of riders fixed on the dial. The product is suitable in use for domestic, commercial and industrial installations.

Construction and Feature

- Available with or without power reserve
- 24 hour dial with 30 min segments
- Permanent ON/OFF switch
- Switching status indication
- Operating indication

Technical Data

- Rated voltage: 230V AC
- Rated frequency: 50/60Hz
- Consumption: 2.5VA
- Contact capacity: 16A/250V AC cycles
- Electrical endurance: 10^5 cycles
- Mechanical endurance: 10^7 cycles
- 24 hours program
- 48 segments
- Min. programmable interval: 30 minutes
- Ambient temperature: -20°C ~ $+50^{\circ}\text{C}$
- Connection terminal: pillar terminal with clamp
- Connection capacity: rigid conductor 6mm^2
- Installation
 - On symmetrical DIN rail
 - Panel mounting

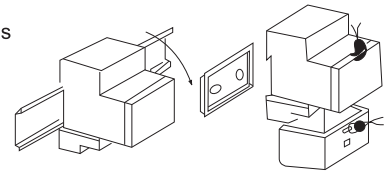

SUL181H Quartz time switch with power reserve

- Drive: quartz-controlled motor
- Frequency: 50/60Hz
- Accuracy: within $\pm 1\text{s}$ per day at 20°C
- Reserve: 150 hours

Overall & Installation Dimensions

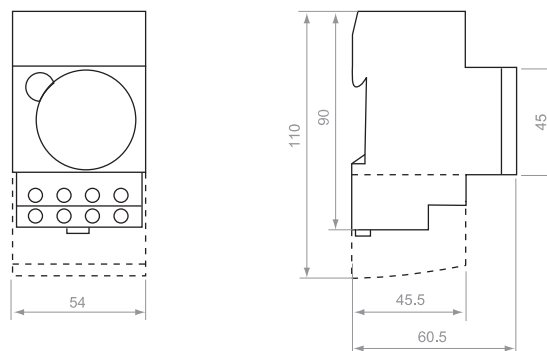

E

